

SL... - ...F3... (Functional cut-off) since 12/2016

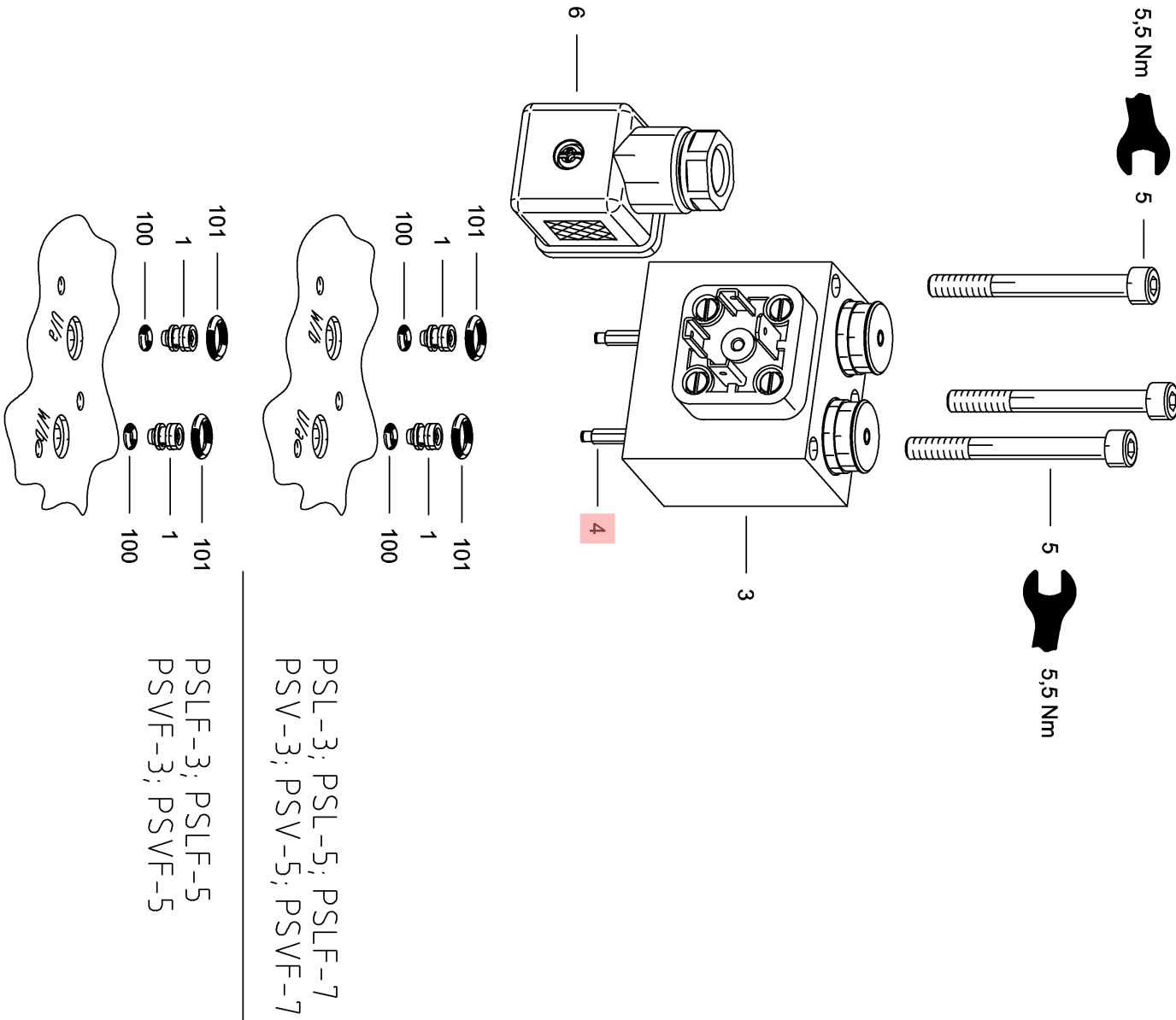

SL... - ...F3... (Functional cut-off) since 12/2016

Item No.	Qty.	Item	Nomenclature	Drawing No.	Add. Information
6850 0120-87	2	1	VALVE INSERT COMPL./ SW	7709 251 K	Complete with O-Rings, Pos. 100 and 101!
4704 8609-00	1	3	TWIN SOLENOID S/W WITH MANUAL EMERGENCY ACTUATION	7709 040 B-12 V	12V DC
4704 8608-00	1	3	TWIN SOLENOID S/W WITH MANUAL EMERGENCY ACTUATION	7709 040 B-24 V	24V DC
3027 4226-00	2	4	ACTUATOR PIN COMPL.	7709 061	
6005 0424-00	3	5	SKT.-HEAD SCREW ISO 4762 - M 5,00 x 50,00 -A2-70		Max. torque 5,5 Nm!
Gerätestecker-2 EN	1	6	Plug Double solenoid EN 175301-803 A / DIN 43650 A / ISO 4400	7163-2	
6096 9639-00	2	100	O-RING 3,00 x 1,50 NBR 90 SH		
6096 9987-00	2	101	O-RING 6,75 x 1,78 HNBR 70 SH		